

Installing an M.2 SSD

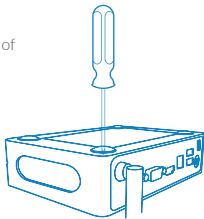

Warning: This user guide assumes familiarity with the common terminology associated with personal computers and with the safety practices and regulatory compliance required for using and modifying electronic equipment. Please disconnect the unit from any power source before performing any of the procedures described in this guide. Failure to disconnect power, before you open the computer or perform any procedures may result in personal injury or damage to the unit.

- 1 Unscrew the four corner screws on the bottom of the unit and lift the cover



- 2 Align the notch located at the bottom edge of the M.2 card with the key in the connector.

Please Note: The Byte3 only supports 80mm M.2.

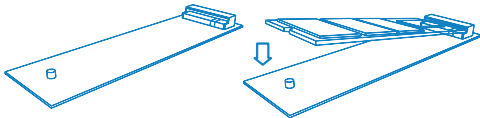

- 3 Insert the bottom edge of the M.2 card into the connector.
- 4 Secure to the brass standoff with the included silver screw that came with your M.2 card.

